









This four bedroom semi-detached house, has been extended to create spacious and versatile accommodation within this ever popular area of Silksworth. Internally the well-presented accommodation on the ground floor includes an entrance porch, an attractive lounge and a dining room with French doors to a rear decked area. There is a fitted kitchen and a downstairs wc, along with a double bedroom, that if required could be utilised as an additional reception room. On the first floor there are three generous bedrooms, a box room / study and a family bathroom/wc, incorporating a shower cubicle. Externally there is a garden to the front with a driveway whilst to the rear there is a lawned garden with decked area. This convenient location is close to local amenities, shops and schools as well as offering transport links to surrounding areas. We highly recommend early viewing to appreciate the accommodation on offer!

MAIN ROOMS AND DIMENSIONS

Ground Floor

Access via Composite door.

Entrance Porch

Inner UPVC door to hall.

Entrance Hall

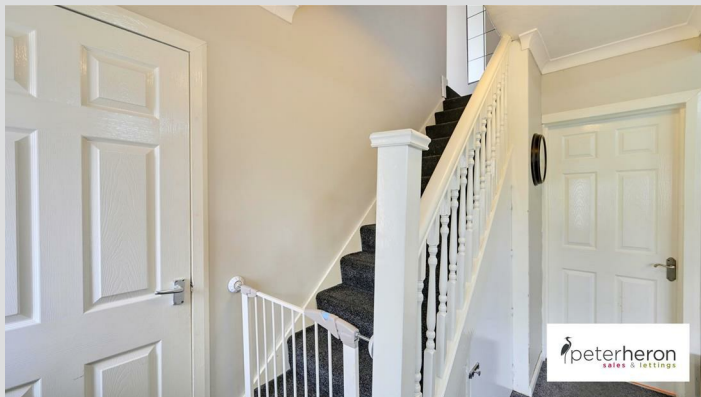

Staircase to first floor with storage under.

Lounge 12'6" x 11'6"



Double glazed bay window to front, radiator, built in shelving and door to dining room.

Dining Room 14'10" x 9'6"



UPVC double glazed French doors to rear, storage cupboard and radiator.

Rear Hall

Door to WC and opens out into kitchen.

Kitchen 10'11" x 6'7"



Wall and base units with working surfaces over incorporating 1 1/2 bowl sink and drainer unit, integrated oven and five burner gas hob, extractor hood, space for fridge freezer, dishwasher and washing machine. Double glazed window and UPVC door to rear.

Family Room/Bedroom 4 15'3" x 10'10"



Double glazed bay window to front and radiator.

First Floor Landing

Double glazed window to front and radiator.

Bedroom 1 11'11" x 10'11"



Double glazed window to front, radiator and built in mirror fronted sliding door wardrobes.

Bedroom 2 11'7" x 11'3"



Double glazed window to front and radiator.

Bedroom 3 11'6" x 10'10"



Double glazed window to rear, radiator and storage cupboard.

Visit www.peterheron.co.uk or call 0191 510 3323

Tried. Trusted. Recommended. City Branch 20 Fawcett Street Sunderland SR1 1RH Fulwell Branch 15 Sea Road Fulwell Sunderland SR6 9BS

MAIN ROOMS AND DIMENSIONS

Dressing Room/Study 6'1" x 5'6"



Double glazed window to rear and radiator.

Bathroom



Low level WC, washbasin, panel bath and walk in shower cubicle, radiator and double glazed window.

Outside



Garden to the front with a driveway whilst to the rear there is a generous laid mainly to lawn with a decked area.

Council Tax Band

The Council Tax Band is Band B.

Tenure Freehold

We are advised by the Vendors that the property is Freehold. Any prospective purchaser should clarify this with their Solicitor.

Important Notice - Particulars

Peter Heron Ltd for themselves and for the vendors of this property whose agents they are, give notice that:- The particulars are set out for general guidance only for the intending Purchasers and do not constitute part of an offer or contract. Whilst we endeavour to make our sales particulars accurate and reliable, if there is anything of particular importance which you feel may influence your decision to purchase, please contact the office and we will be pleased to check the information. Do so particularly, if contemplating travelling some distance to view the property. All descriptions, dimensions, references to conditions and necessary permissions for use and occupation and other details are given in good faith, and are believed to be correct, however any intending purchasers should not rely on them that statements are representations of fact, but must satisfy themselves by inspection or otherwise as to the correctness of each of them. Independent property size verification is recommended.

Lease details, service charges and ground rent (where applicable) are given as a guide only and should be checked and confirmed by your Solicitor prior to exchange of contracts. No person in the employment of Peter Heron Ltd has any authority to make or give any representation or warranty whatever in relation to this property or these particulars, nor to enter into any contract on behalf of Peter Heron Ltd, nor into any contract on behalf of the Vendor. The copyright of all details and photographs remain exclusive to Peter Heron Ltd.

Please note that in the event the purchaser uses the services of Peter Heron Conveyancing in the purchase of their home, Peter Heron Ltd will be paid a completion commission of £300.00 by Movewithus Ltd.

Fawcett Street Viewings

To arrange an appointment to view this property please contact our Fawcett Street branch on or book viewing online at peterheron.co.uk

Opening Times

Monday to Friday 9.00am - 5.00pm Saturday 9.00am - 12noon

Ombudsman

Peter Heron Estate Agents are members of The Property Ombudsman and subscribe to The Property Ombudsman Code of Practice.

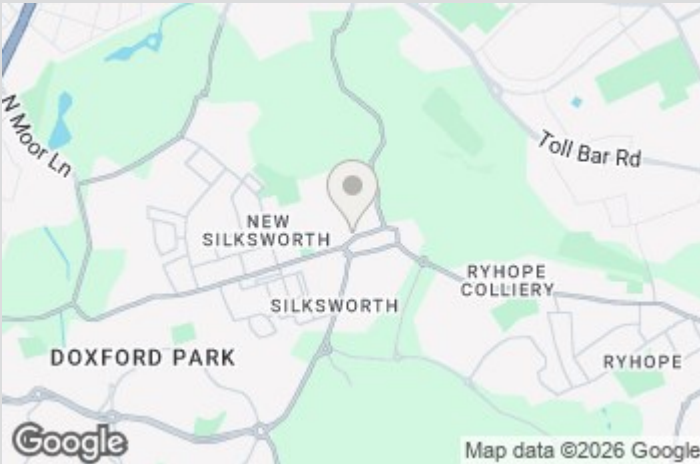
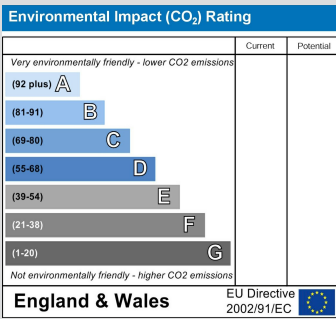
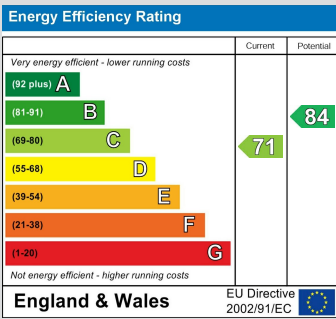

Visit www.peterheron.co.uk or call 0191 510 3323

Tried. Trusted. Recommended. City Branch 20 Fawcett Street Sunderland SR1 1RH Fulwell Branch 15 Sea Road Fulwell Sunderland SR6 9BS

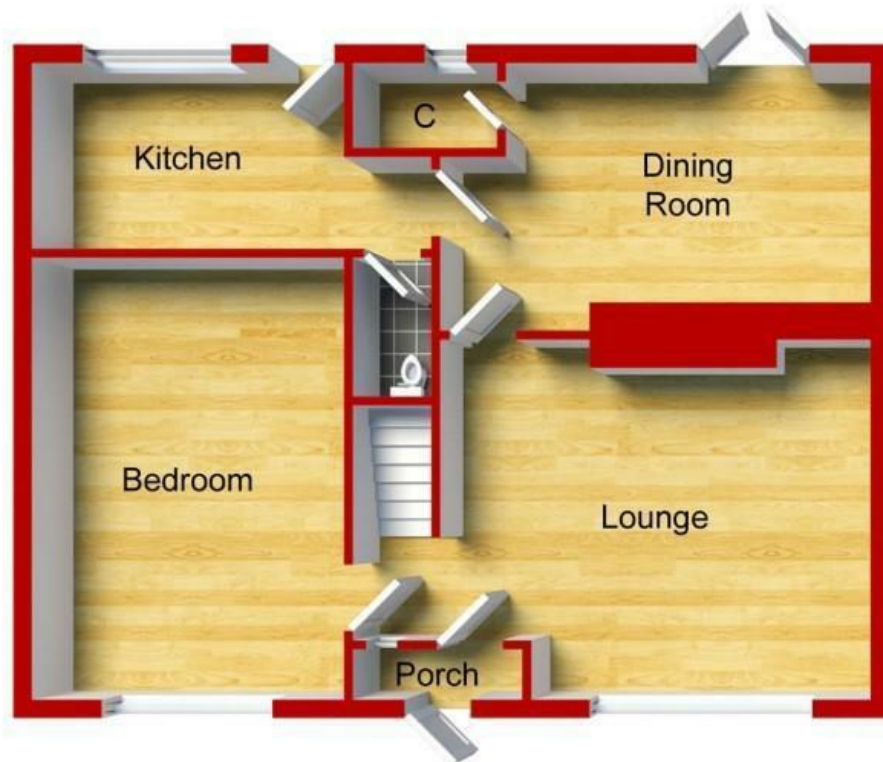

Ground Floor
Approximate Floor Area
(63.80 sq.m)

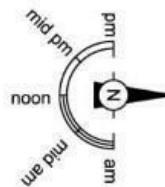

First Floor
Approximate Floor Area
(62.68 sq.m)

28 Maple Avenue